



BAUER SOLARTECHNIK **PERFORMANCE** BS-108M10HB 400 - 410 W

MONOCRYSTALLINE HALF-CELL MODULE



BAUER guarantees a minimum performance value of 87,2% after 25 years for the **PERFORMANCE** glass-foil solar modules.

A comparison of **BAUER** glass-foil solar modules performance guarantee to conventional glass-foil modules according to industry standards:

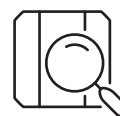
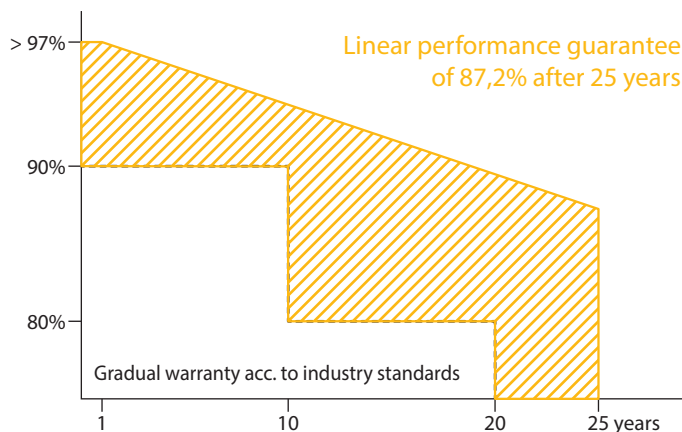

PID TEST

The solar cells of this module are tested for Potential-induced Degradation (PID)



CERTIFICATION

Constant in-house quality controls - certified several times over by accredited inspection bodies



HALF-CELL TECHNOLOGY

Double the amount of cells on the same surface area reduces power loss in case of e.g. shadowing



GERMAN GUARANTOR

If necessary, it is guaranteed that a German company takes over any claim settlements



PERFORMANCE GUARANTEE

20 year product warranty and a linear performance guarantee over a period of 25 years



REINSURANCE COVERAGE

BAUER is reinsured for 25 years of the product's performance guarantee

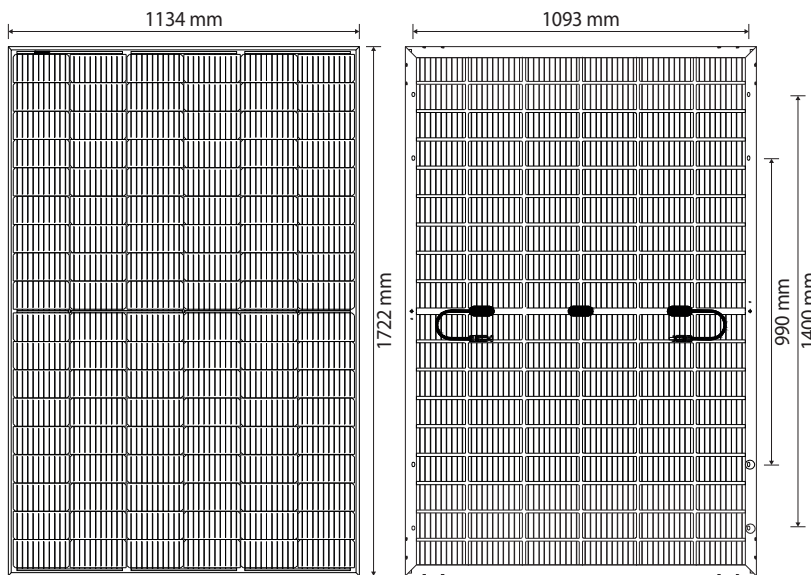

BAUER SOLARTECHNIK PERFORMANCE

BS-108M10HB 400 - 410 W

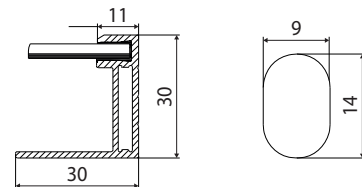

WARRANTIES¹

20 years product warranty

25 years performance guarantee

PHYSICAL SPECIFICATIONS

| | |
|--------------------|---|
| Module dimensions | 1722 x 1134 x 30 mm |
| Weight | 21,4 kg |
| Frame | Anodized aluminium alloy (black) |
| Frontside | Performance anti-reflection glass, 3,2 mm |
| Embedding material | EVA |
| Backside | Foil (white) |
| Solar Cells | 108 monokristalline half-cells |
| Bifaciality | - |
| Junction box | IP68, 3 bypass diodes |
| Cable & connector | 1x4 mm ² , 1300 mm, MC4 compatible |

OPERATING CONDITIONS

| | |
|-----------------------|---------------------|
| Operating temperature | -40 to 85°C |
| Static load | 5400 Pa (snow/wind) |
| Hail | Ø 25 mm at 23 m/s |

CERTIFICATION

IEC 61215, IEC 61730

PACKAGING

| | |
|---------------------------|--------|
| Modules per pallet | 36 |
| Pallets/modules per truck | 26/936 |

ELECTRICAL CHARACTERISTICS²

| | | BS-400-108M10HB | BS-405-108M10HB | BS-410-108M10HB |
|---|------------------------------------|-----------------|-----------------|-----------------|
| Maximum power | P _{max} (W) | 400 | 405 | 410 |
| Power output tolerance | P _{max} (%) | 0 ~ +3 | 0 ~ +3 | 0 ~ +3 |
| Open circuit voltage | V _{oc} (V) | 37,20 | 37,36 | 37,54 |
| Short circuit current | I _{sc} (A) | 13,68 | 13,78 | 13,86 |
| Voltage at maximum power | V _{mpp} (V) | 31,17 | 31,36 | 31,55 |
| Current at maximum power | I _{mpp} (A) | 12,84 | 12,92 | 13,00 |
| Module efficiency | η _m (%) | 20,49 | 20,75 | 21,00 |
| Nominal operating cell temperature | NOCT (°C) | 45 +/- 2 | | |
| Temperature coefficient of Voc | T _k (Voc) | -0,27 %/°C | | |
| Temperature coefficient of Isc | T _k (Isc) | +0,048 %/°C | | |
| Temperature coefficient of P _{mpp} | T _k (P _{mpp}) | -0,32 %/°C | | |
| Maximum system voltage DC (TÜV) | (V) | 1500 | | |
| Maximum series fuse rating | (A) | 30 | | |

¹Nominal value is specified in the written warranty conditions. A possible light-induced degradation in performance is not taken into account. ²Values under Standard Test Conditions (STC): air mass 1,5 AM, irradiance 1000 W/m², cell temperature 25°C. STC measuring tolerance: ±3 % (P_{max}), ±10 % (V_{max}, I_{mpp}, V_{oc}, I_{sc}). The beneficiary under the reinsurance policy is solely Bauer Solar GmbH. Please contact us to get information on how this insurance coverage benefits you as a customer. Note: please read the safety instructions and installation manual before using this product.
Subject to change. © 2023 Bauer Solar GmbH. Effective: 19/05/23.

DISTRIBUTION